



Doctor Vida

Your pocket PCR



Equipment Doctor Vida® and software



Instructions for use



Reference: 133001002,133001003

HW version: 2.4.1; FW version: 6.1.1; Software Version: 3.2.0

Document version (v7): 03, February 2025

Partial and/or total reproduction by any means of this document is expressly prohibited.

Doctor Vida® is a trademark of STAB VIDA- Research and Services in Biological Sciences, Lda.

The manufacturer continues to improve its products and reserves the right to change the information at any time.

If the product is used in a manner other than that specified by the manufacturer, the device may be compromised. Refer to the warnings, precautions, measures to be taken, and limitations of use for the product.

The images, screenshots present in the document are for illustrative purposes only.

Content

Intended purpose	4
Principles of operation	4
Quality Control	4
Applicable symbols	5
Abbreviations	6
Technical Specifications	7
Warnings, precautions, safety measures and limitations of use.....	8
Electricity	8
Fluids and reagents	8
Physical medium	8
Electrostatic discharge (ESD)	8
Operating environment.....	8
Equipment Ratings	9
Before starting the trial.....	10
Materials provided	10
Materials required but not provided.....	10
Performance characteristics	11
Sample collection, handling, preparation and analysis.....	11
Installation	12
Install the Doctor Vida equipment	12
Daily preparation of the workplace and the Doctor Vida equipment before starting trials	12
Install the software	13
Minimum hardware requirements for software to work as intended.....	13
Characteristics of computer networks and computer security measures.....	13
Software	14
Permissions	14
Account.....	14
If you don't have an account, create an account	14
If you have an account.....	14
Home Screen	15
Menu Bar	15
Operation of the software.....	20
After the rehearsal	28
Maintenance	28
Site and equipment cleaning	28
Waste disposal	28
Troubleshooting	29
Warranty Information	31
Training	31
Manufacturer Information.....	31
Revision history.....	32

Intended purpose

The Doctor Vida equipment (reference 133001002) is a semi-automatic instrument for isothermal amplification and qualitative molecular detection of nucleic acids by fluorescence. If there is no fluorescence emission or if it is residual, the target nucleic acids (e.g. RNA or DNA) are not detected or are below the detection limit of the technique. The equipment is fully controlled by a mobile phone application (Dr Vida Pocket PCR, reference 133001003) intended for research purposes. You are responsible for complying with safety procedures, including the use of necessary personal protective equipment, maintenance of equipment and facilities, and waste management.

Principles of operation

The Doctor Vida equipment should be used in combination with compatible reagents (Dr Vida Tests) and the Doctor Vida Pocket PCR mobile phone application (133001003 reference), available on the App Store (Apple) and Play Store (Google), following the information described in the document.

Biological samples are collected by healthcare professionals following the good practice procedures referred to in the Dr Vida test instructions. The biological sample is added to the test tube and introduced into the Doctor Vida equipment for analysis. The Dr Vida Pocket PCR mobile app allows you to control the instrument and view the real-time analysis progress and result.

Quality Control

The Quality Report of the final product is available whenever requested by the customer. See the Manufacturer [Information section](#).

Applicable symbols



See instructions for use



Conformity with the European Union requirements from European Union related to safety and electromagnetic compatibility



Product Reference



Research Use Only



Serial number



Temperature limits



RoHS Compliance



Direct current (DC)



Manufacturer



For internal use



Expire date



Atenção:

Follow the instructions presented in this document; Improper use may cause damage to the device or your health



Waste electrical and electronic equipment (WEEE) (Directive 2012/19/EU)

This symbol on the product or its packaging indicates that it should not be disposed of like other household waste. It is your responsibility to dispose of the device properly for the recycling of waste electrical and electronic equipment. The collection and selected recycling of this equipment helps to conserve natural resources and protect human health and the environment. For more information on where you can dispose of the device, contact the manufacturer or distribution company where you purchased the product.

Abbreviations

Abbreviation	Meaning
CC	Direct current
CE	European Compliance
CQ	Quality Control
EN	European standard
UE	European Union
FW	<i>Firmware</i>
HW	<i>Hardware</i>
IEC	International Electrotechnical Commission
LED	Diode emissor of light
N/A	Not applicable
PDF	Portable document format
REEE	Waste electrical and electronic equipment

Technical Specifications

Parameter	Specification
Power supply	LEDs: Verde (570nm +/- 20nm). Azul (470nm +/- 35nm)
Detection System	Silicon CMOS sensor with integrated Gaussian filters, 6 channels of multispectral detection at the visible wavelength between approximately: 430nm - 670nm with a half-height width (FWHM) of 40nm
Spectrum Channels	450, 500, 550, 570, 600 and 650 nm (+/-20nm)
Thermal System	Between +5°C (above ambient temperature) and +95°C. Max. heating: 0.22°C/sec.
Dimensions (h x w x d)	33,11 mm x 75,80 mm x 44,45 mm
Weight	58 Grams
Humidity Conditions	20% to 80%, non-condensing
Safety ambient temperature conditions	+5°C to +40°C The equipment is safe within normal safety conditions (IEC/EN 61010-1)
Ambient temperature conditions during equipment use (Operating Temperature)	+15°C to +30°C
Transport temperature	Room temperature
Power Supply Electrical Characteristics (Input/Output)	Entrance: 100- 240 VAC, 50/60 Hz Output: 5VDC, 2A
Electrical characteristics of the Doctor Vida equipment (Input)	5VDC, 1A
Maximum Usage Altitude	2 000 m
Bluetooth®	Bluetooth V4.2 BR/EDR, Bluetooth LE GPS / Camera Activated
Internet connection	IEEE 802.11b/g/n or mobile data
Warranty	Two years
Consumables	Compatible only with supplied plastic consumables

Warnings, precautions, safety measures and limitations of use

All users must read and comply with the instructions for use provided.

Failure to follow the instructions may cause damage to the equipment and/or cause damage to health. For your safety and to prevent damage to the equipment, it is important that the following safety precautions are read and understood before using the equipment. Please refer to the product datasheet for details.

Electricity

Standard electrical safety precautions shall be applied, including the following:

- ▶ Always place the machine in a location where, if necessary, the power supply can be immediately switched off.
- ▶ Use only the supplied power supply (Input: 100 – 240VAC, 50/60Hz| Output: 5VDC, 2A), or a similar certified power supply with the same specifications to operate the equipment.
- ▶ The maximum fluctuation for the main supply voltage is +- 10%.
- ▶ Do not touch switches or outlets with wet hands, or operate the equipment in wet environments.
- ▶ Do not operate the equipment if you detect any anomaly in the equipment and/or the power supply supplied, such as deformations, fractures, exposed wires, liquid spills, etc.
- ▶ Unplug the appliance from the wall outlet before cleaning it or to clean up any major liquid spills.
- ▶ Do not service electrical components unless you are qualified and authorized to do so.
- ▶ In the event of an electrical power failure, the analysis is interrupted and the test is invalid. The test tube should be discarded and the test will have to be repeated with a new test tube.

Fluids and reagents

- ▶ Always handle liquid samples and transfer them to the test tube away from the equipment to prevent any fluids from penetrating the inside of the equipment.
- ▶ Never incubate explosive, flammable and/or reactive substances in the equipment.
- ▶ Never immerse the equipment in any liquid at any time.

Physical medium

- ▶ Do not use the equipment on materials (plates, fences, sheets, mats, etc.) that are not sufficiently resistant to high temperatures. Note that during operation, it is normal for the equipment to heat up slightly, especially underneath it.
- ▶ Never touch the inside of the equipment, to avoid the risk of burning.
- ▶ Do not use other materials (plates, slides, etc.) instead of test tubes designed to be operated with the equipment.

Electrostatic discharge (ESD)

- ▶ The equipment is sensitive to static. Electrostatic discharges greater than 2000 volts can interfere with the normal operation of the USB ports on the equipment. Handling precautions are necessary when working in environments with high static. In environments of high static electricity, wear an anti-static wrist strap and take other anti-static precautions before handling the equipment - ESD STM5.1-1 1998 Class 1C.

Operating environment

- ▶ Operate the equipment indoors only, with an ambient temperature between 15°C and 30°C and humidity levels between 20% and 80% (non-condensing).
- ▶ Não operar o equipamento em um ambiente perigoso ou potencialmente explosivo.
- ▶ Do not attempt to remove the cap and/or test tube, or move the equipment, while it is performing a test.

► Operate the equipment only on a level surface, with the lid facing upwards.

Equipment Ratings

Power supply: 100-240 VAC, 50/60 Hz

Equipment Input Supply: 5VDC, 1A (min.)

Pollution degree 2

Installation Category II

Operating humidity: 20% to 80%, non-condensing

Operating temperature: 15°C to 30°C

Bluetooth®: Bluetooth V4.2 BR/EDR and Bluetooth LE specification with GPS and camera support

Wi-Fi: IEEE 802.11b/g/n and mobile data

For indoor use only

RoHS compliant

Before starting the trial

Check the contents of the package using the list of materials supplied. If any of the items are missing or damaged, contact the manufacturer immediately.

Materials provided

Description	Reference	Quantity	Storage conditions
Life Doctor Equipment (included power supply and micro cable USB-B)	133001002	1 unit	+5°C a +40°C

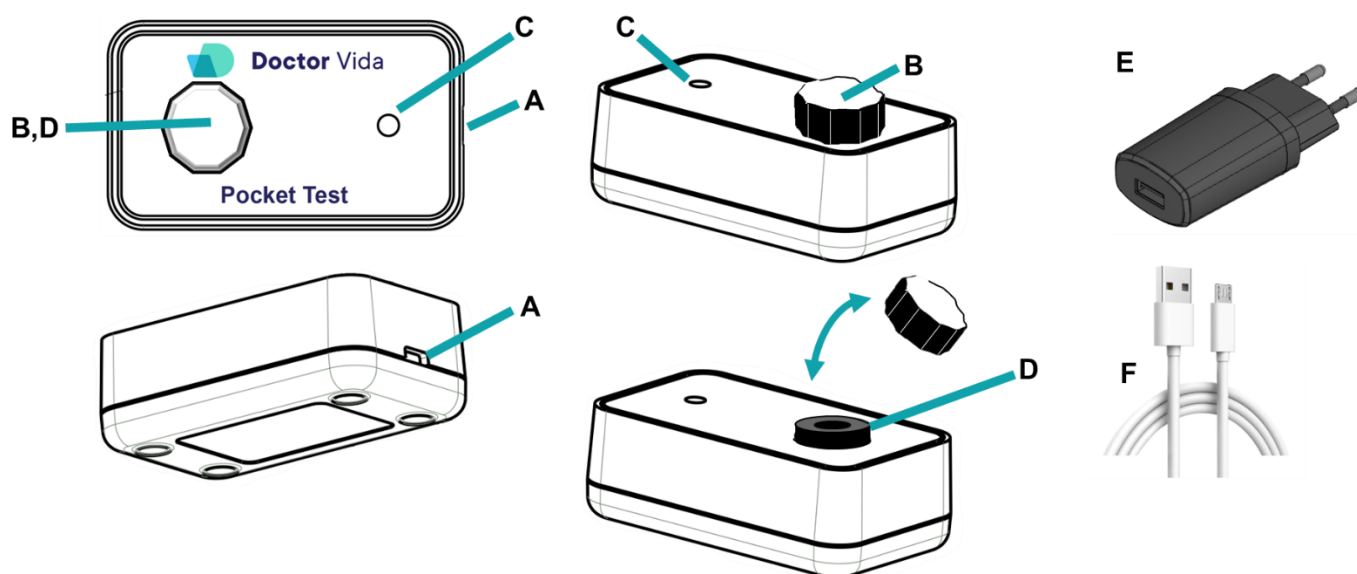

A ▶ Door USB-B	B ▶ Protective cover of the reaction chamber	C ▶ Light indicator	D ▶ Reaction chamber	E ▶ Power supply	F ▶ Cabo micro USB-B
----------------	--	---------------------	----------------------	------------------	----------------------

Dr Vida Pocket PCR app (available on Google Play and iOS stores)	133001003	1 unit	Not applicable
--	-----------	--------	----------------

Materials required but not provided

- ▶ Mobile phone with Bluetooth – to install and use the Dr Vida Pocket PCR application.
- ▶ Internet (wireless) – required to start and end the test (transfer of data to the server).
- ▶ Reagents - Ask for the list of tests available and compatible with the Doctor Vida equipment and *software*.

Performance characteristics

Refer to the performance characteristics information in the instructions for use provided with the Dr Vida tests compatible with the Doctor Vida equipment and *software*.

Sample collection, handling, preparation and analysis

Please refer to the information on sample collection, handling, preparation and analysis procedures in the instructions for use provided with Dr Vida tests compatible with Doctor Vida equipment and *software*.

Installation

Install the Doctor Vida equipment

Please read the following information carefully before attempting to use the machine for the first time.

Daily preparation of the workplace and the Doctor Vida equipment before starting trials

Important Note 1: If the equipment is not on a flat surface, the performance of the test may be affected.

Important Note 2: Do not allow ethanol to enter the hole where the test tube is placed.

- ▶ Clean and disinfect the work surface with 10% bleach and 70% ethanol to control infectious hazards. After cleaning the surface, place the machine on a flat surface.
- ▶ Remove the cover from the equipment and clean it with paper moistened with 70% ethanol (do not spray). Let it air dry.
- ▶ Screw the lid onto the equipment and wipe the entire outside with paper moistened with 70% ethanol (do not spray).
- ▶ Connect the equipment to the electrical outlet with an output power 5VDC, 2A. The equipment may take a few minutes to stabilize the temperature.

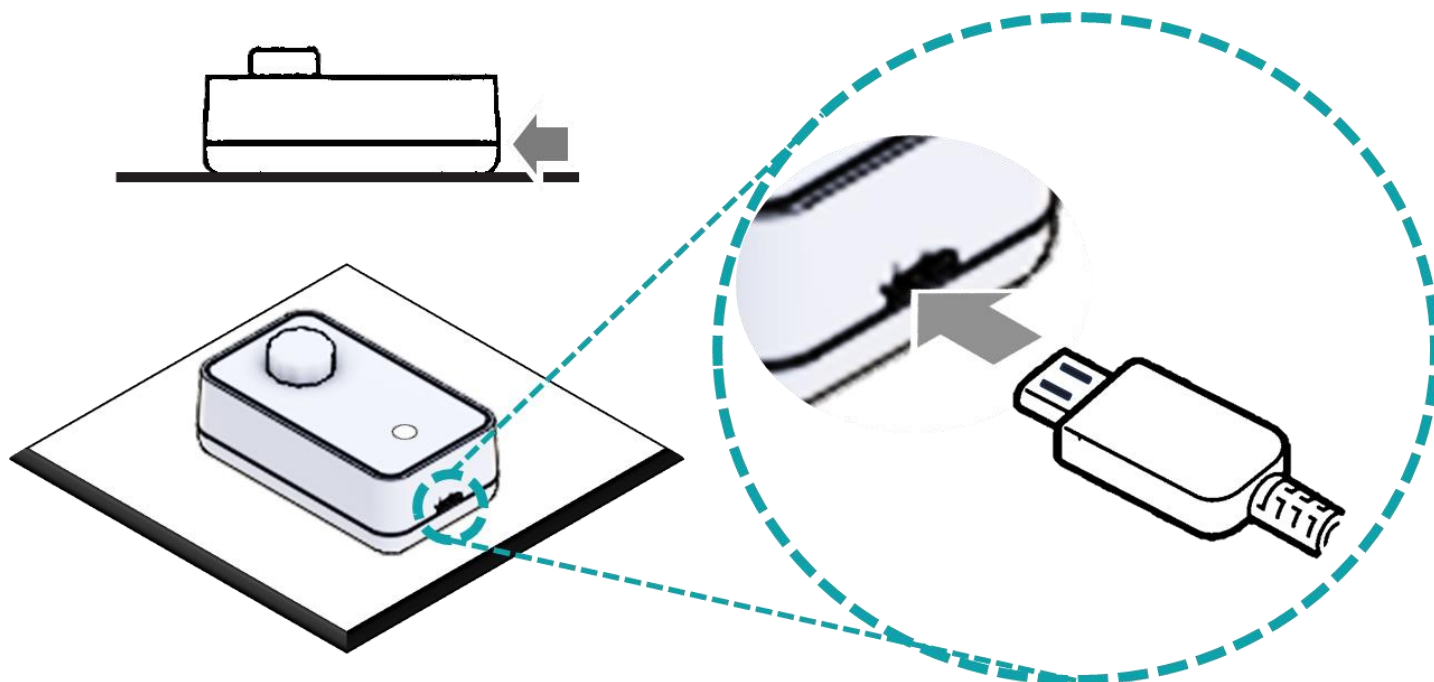

- ▶ Remove the lid and leave the appliance on approximately 30 minutes before the first use of the day.

Install the software

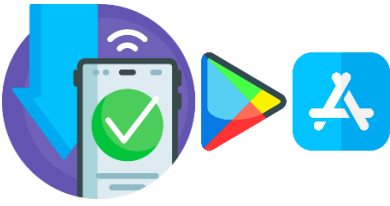

The Dr Vida Pocket PCR application can be downloaded to the mobile phone, available on the App Store (Apple) and Play Store (Google).

Minimum hardware requirements for software to work as intended

Android phones: Operating system > 5.0

iOS phones: Operating system > 11.0

Make sure you have an internet connection and that Bluetooth is working before starting the test. It is recommended to have a Bluetooth version > 5.0 and a stable WiFi connection.

Check your device's hardware compatibility requirements with the software in the compatibility section within each store (Android/iOS).

Characteristics of computer networks and computer security measures

The design and maintenance of the software follows the internal procedure.

Software

Permissions

To be able to use the Dr Vida Pocket PCR application, you must give permission for the use and storage of data, camera and location. See the privacy policy (<https://www.doctorvida.com/privacy.html>) for more details.

Account

If you don't have an account, create an account

Select "New user? Create account", fill out the form and select "Create account".

The image shows two side-by-side mobile app screens. The left screen is the login page, featuring the 'Doctor Vida' logo at the top. It has two input fields for 'Email' and 'Password', a link for 'Esqueci a minha senha' (Forgot my password), and a large 'Entrar' (Sign in) button. At the bottom, it says 'Novo utilizador? Crie conta' (New user? Create account). The right screen is the account creation page, titled 'Criar a sua conta'. It asks the user to 'Escolha as suas preferências para a emissão de certificados' (Choose your preferences for certificate issuance). It includes fields for 'Nome' (Name), 'Apelido' (Surname), 'E-mail' (with a note to provide a valid email), and a dropdown menu for 'País onde se realizam os testes' (Country where tests are performed), currently set to 'Portugal'. There are also fields for 'Senha' (Password) and 'Confirmar senha' (Confirm password), with a note to choose a secure password. At the bottom, it says 'Ao criar esta conta, aceita todos os Termos e Condições' (By creating this account, you accept all Terms and Conditions) and has a 'Criar conta' (Create account) button. A link 'Já disponho de uma conta' (I already have an account) is at the very bottom.

If you have an account.

Enter your registered email and password and click "Sign in".

Note: Make sure the email is valid, otherwise you will not receive the test results.

Home Screen

Menu Bar

The menu bar consists of the **Devices, Tests in progress, Results, and Settings menus**.

Home

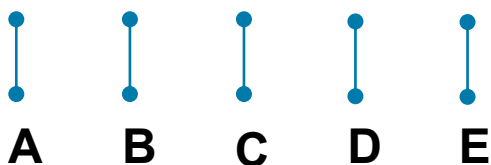
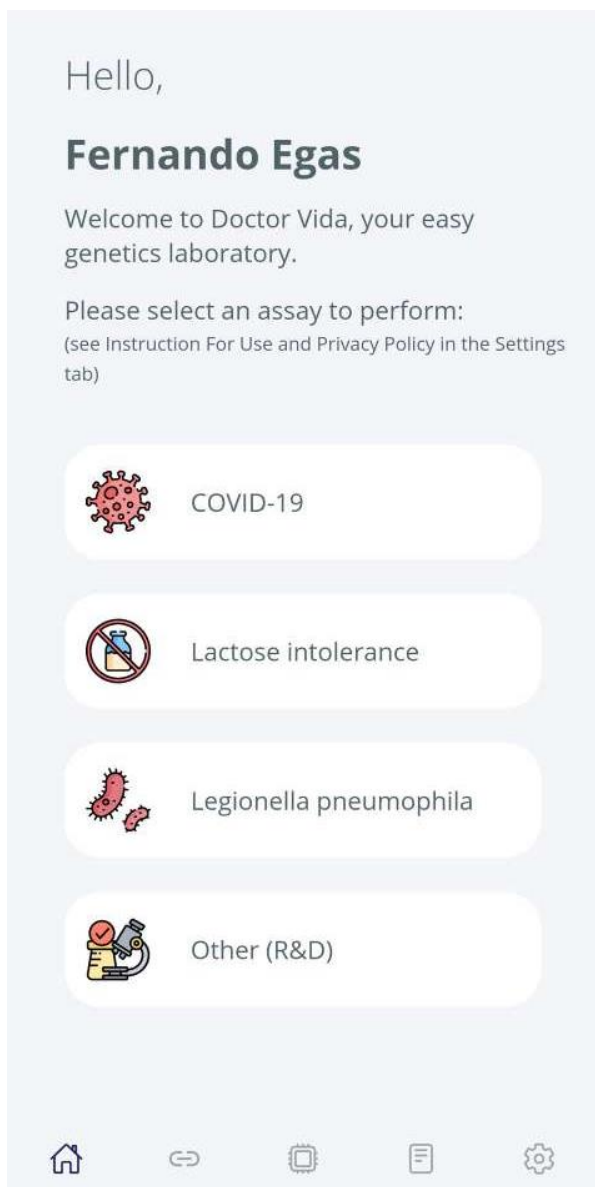

- A ► Menu Principal (Home)
- B ► Devices
- C ► Ongoing trials
- D ► Results
- E ► Definitions

Devices



In this menu you can check and select the devices available to perform the tests. Only devices recognized by Bluetooth and their current status will be shown.

Slide the button on the devices you want to pair. Click "Connect" and "Continue". The devices will be ready to take the test.

If one or more devices don't appear in the list, just refresh the list by swiping down on the screen.

If not, make sure that:

The desired device is turned on and not connected to another phone, Bluetooth is enabled on the phone.

Otherwise, see the section: Troubleshooting.

It is possible to connect up to 4 devices and operate them simultaneously.

Pay attention to the device status legend (click on the icon?):

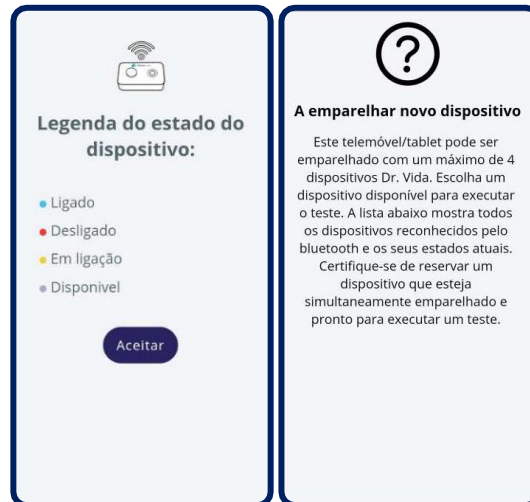

1

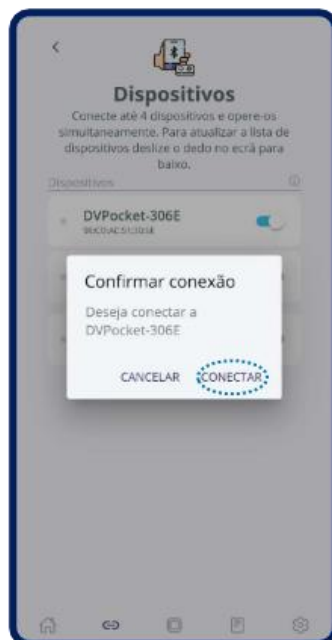

2

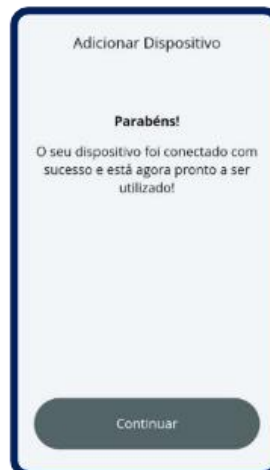

3

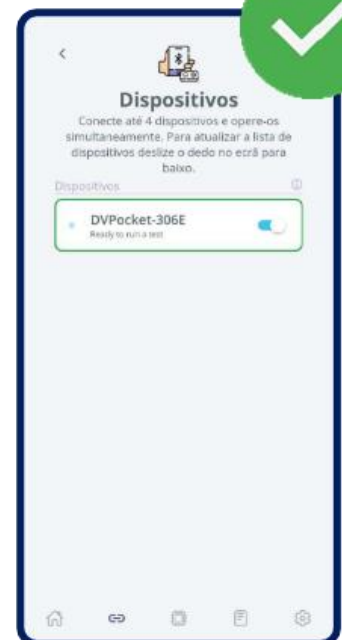

4

Ongoing trials

In this menu you can check and consult information about the tests that are in progress. You can operate and view the progression of 4 devices (maximum) at the same time for each phone. In this menu, you can filter by device and check the details of each test individually.

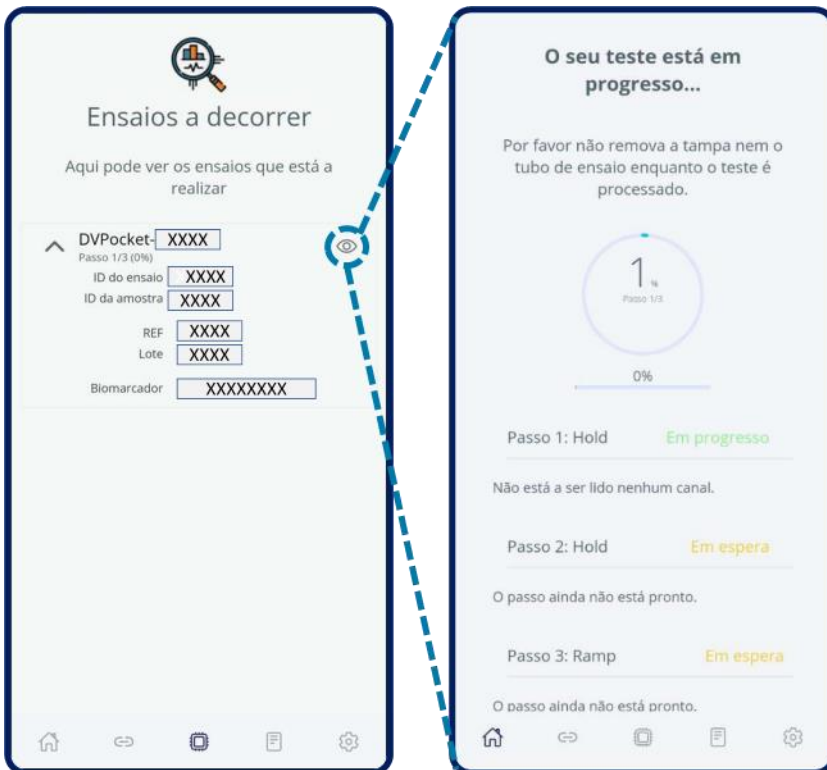

Results

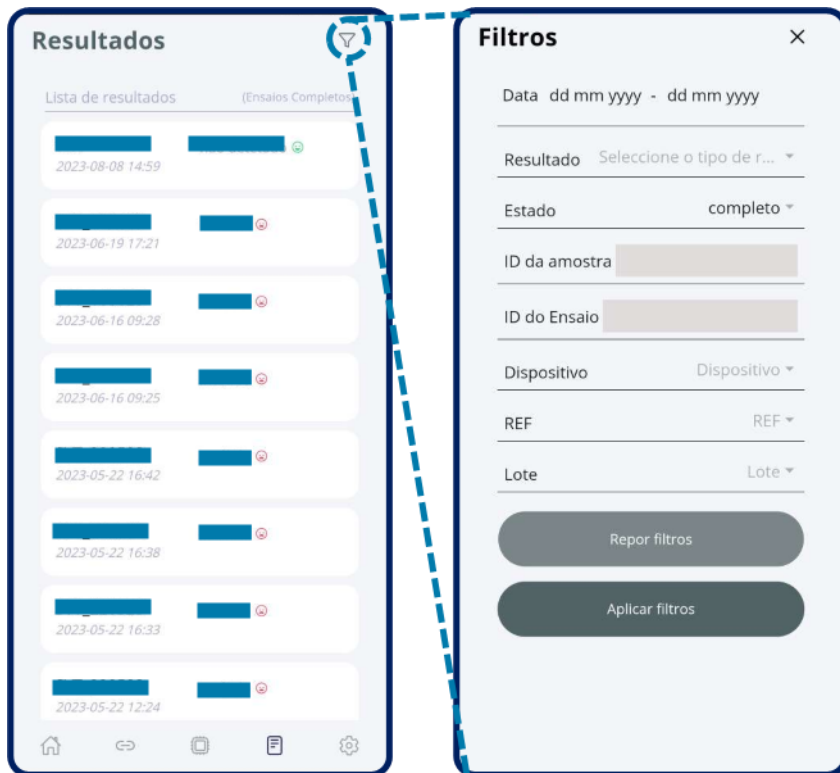

In this menu you can check and consult information about the results of the selected tests.

Definitions

In this menu you can check profile information, select the language and colour, the manufacturer's contacts, set the certificate options (test results report), instructions for use (also available in www.doctorvida.com) and privacy policy (also available in www.doctorvida.com)

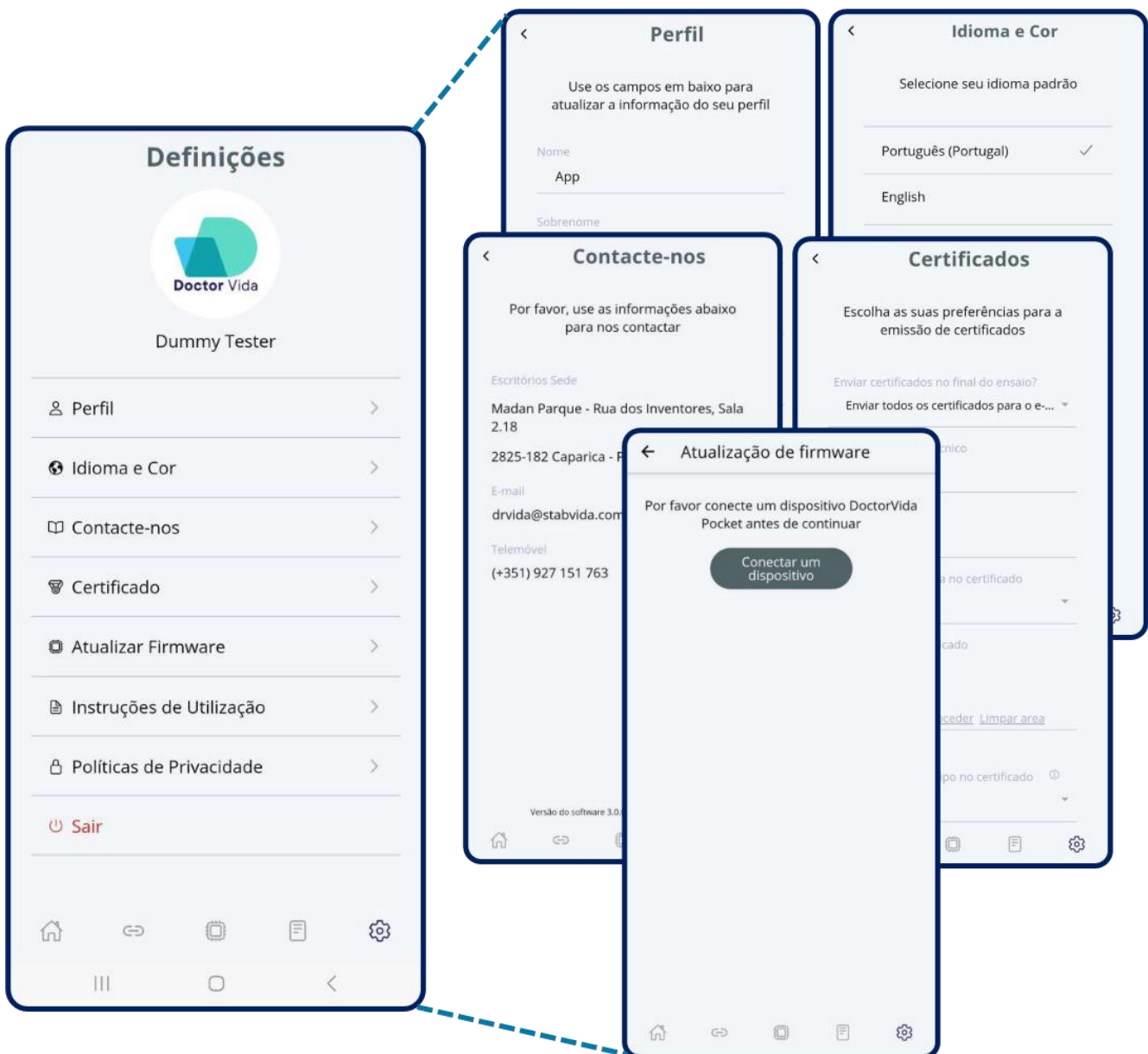

Operation of the software

Open the app.

To start a trial, turn on the Doctor Vida equipment.

Connect the equipment to the mains, output: 5VDC, 2A. It may take a few minutes for the equipment to stabilize the temperature.

In the app, connect the equipment. On the home screen, click on "Devices" and slide the button on the devices you want to pair. Click "Connect" and "Continue". The equipment will be ready to do a test.

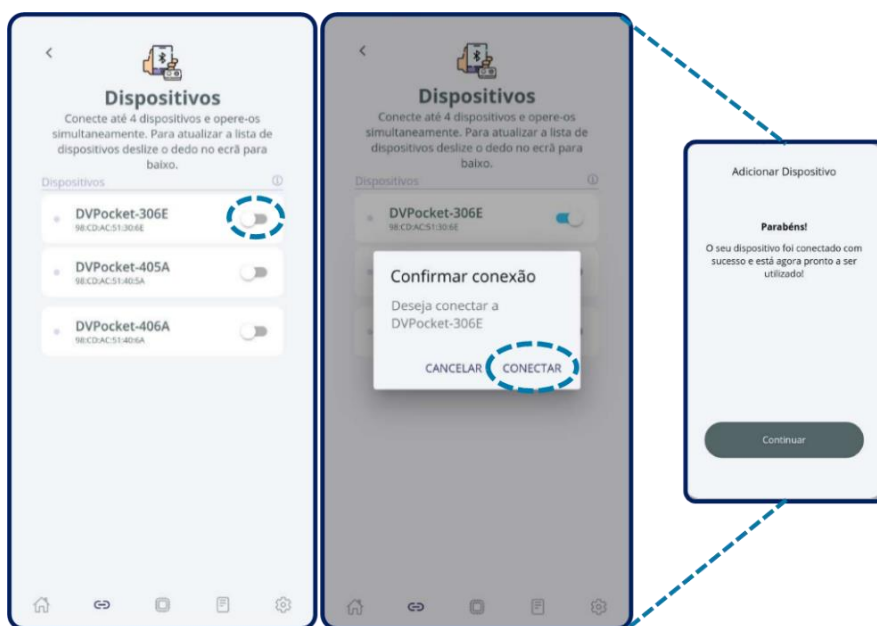

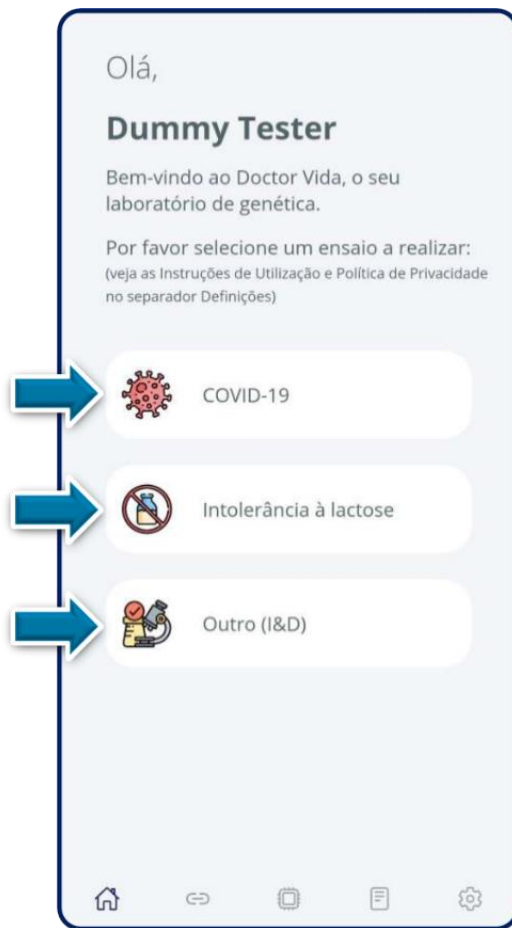

Select the "HOME" screen and choose the test you want to perform:



Once you have chosen the desired test, pay attention to the following screen that appears, check the color code.

Orange menu – information required

Lilac menu – you can't select until you fill in the information above.



There is the option to enter the data manually or scan the QR code with the mobile phone

1



Click the "Select Device" option or the QR code icon of the device

Select the device that is ready to perform a test by clicking on the device box or scan the device QR code on the device labeling.

The device QR code is on the labeling on the top or bottom of the device.

2



Once step 1 is fulfilled, the box turns green and the device ID will be shown in the green box.



Click the option to enter the information or scan the QR code of the reagents

Enter the reference number (REF) and batch of the reagents (LOTE) or scan the QR code present on the package labeling.

This will allow you to identify the test protocol and choose the analysis algorithm for the data collected while the new test is running.

The QR code of the reagents must have a standard format as mentioned in the App.

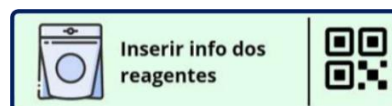

Once step 2 is fulfilled, the box turns green.

3

< Informação da Amostra

Preencha a informação da amostra

ID da amostra

Tipo da Amostra

Tipo de Resultado do Teste ⓘ

Teste sem Certificado no Final

Teste com Certificado no Final

Mais detalhes ▾

Próximo

Tipo de Resultado do Teste

Se escolher com Certificado terá de preencher obrigatoriamente alguns dados do paciente e confirmar que as informações do certificado (no menu Definições) estão corretas.

OK

Click to enter the information or scan the sample QR code

Fill in the information or scan the sample QR code.

An anonymous alphanumeric code is recommended for sample identification.

The sample QR code should have a standard format as stated in the App.

< Informação da Amostra

Mais detalhes ▲

Nome do paciente **obrigatório**

Documento de identificação **obrigatório**

Seleccione o tipo de Documento ▾

Número de identificação **obrigatório**

Email para envio dos resultados

Número de telemóvel

Género

Seleccione o género ▾

Data de nascimento

< Informação da Amostra

Email para envio dos resultados

Número de telemóvel

Género

Seleccione o género ▾

Data de nascimento

Número de utente

Código postal

0000-000

Próximo

If you select the test with certificate there is mandatory information to fill in and confirm that the certificate information (in the Settings menu) is correct.

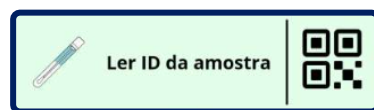

If you select the test without a certificate – only the sample ID is required.

After filling out the form, click "Next" and the "Read Sample ID" box turns green:



Once step 3 is fulfilled, the box turns green.

Click on "Continue" and follow the instructions provided in the Dr Vida Pocket PCR app regarding the protocol for collection, handling and preparation of the sample for analysis depending on the chosen assay.

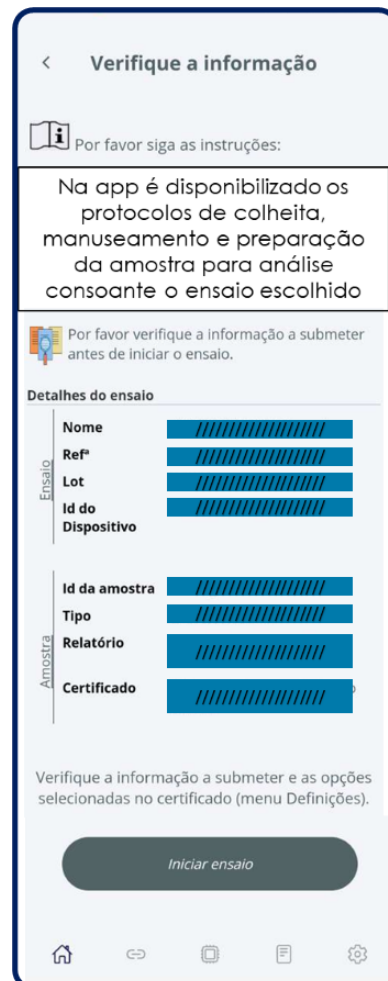

At the end, check the necessary information before starting the test, in case the information needs to be corrected, click on the arrow at the top left of the screen and return to the previous screen.



After selecting the "Start test" button, the system will check if the requirements necessary to start the test are met. Make sure that the device does not have any test tubes from the previous test. If so, you will hear a beep. Please take it off to continue.

Important note: Do not touch or touch the device while the test is being processed, as this may affect the performance of the test.

Important note: If you lose Bluetooth or internet connection during tests, you do not lose the information. NEVER disconnect the device from the plug. Close the App, open the App again, and select the "Devices" screen to reconnect the devices that are in progress. Then click the device(s) again and click to "summarize tests" to resume the tests.

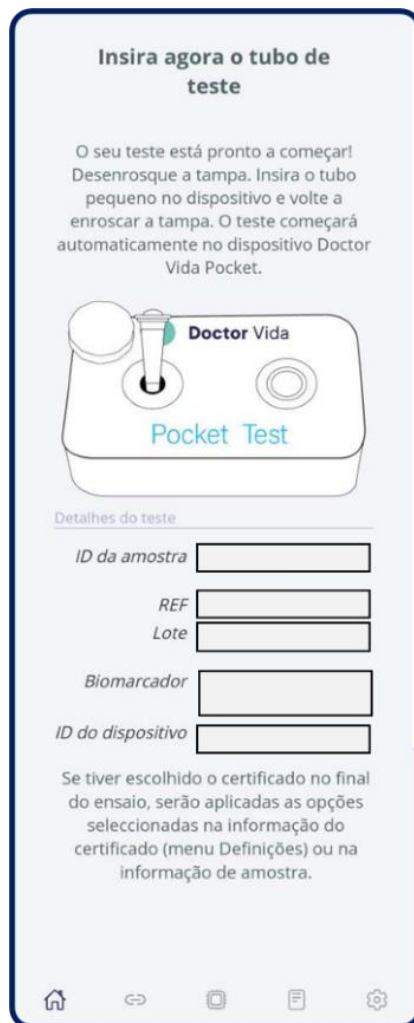

Now insert the test tube - Make sure that the tube is securely closed. Unscrew the cap (counterclockwise), insert the tube into the device and screw the cap on (clockwise). The test will start automatically.

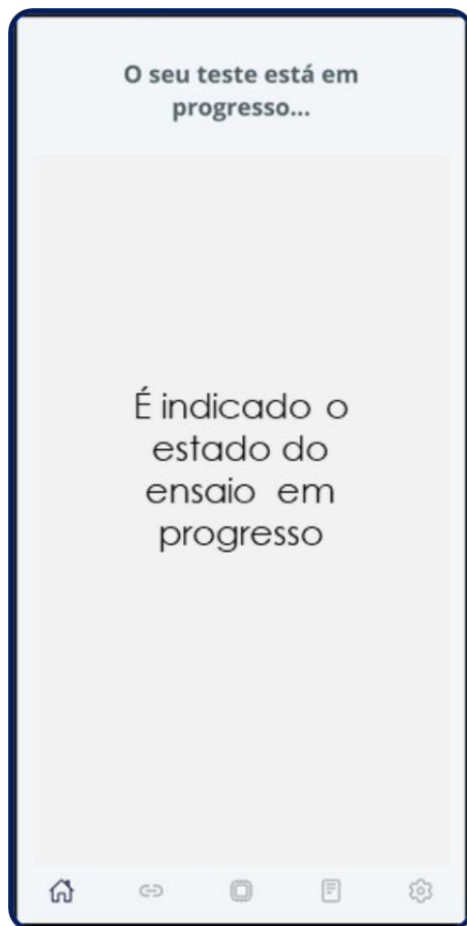

Important note: Please do not move or move the device while the sample is being processed as it may compromise the reliability of the result.

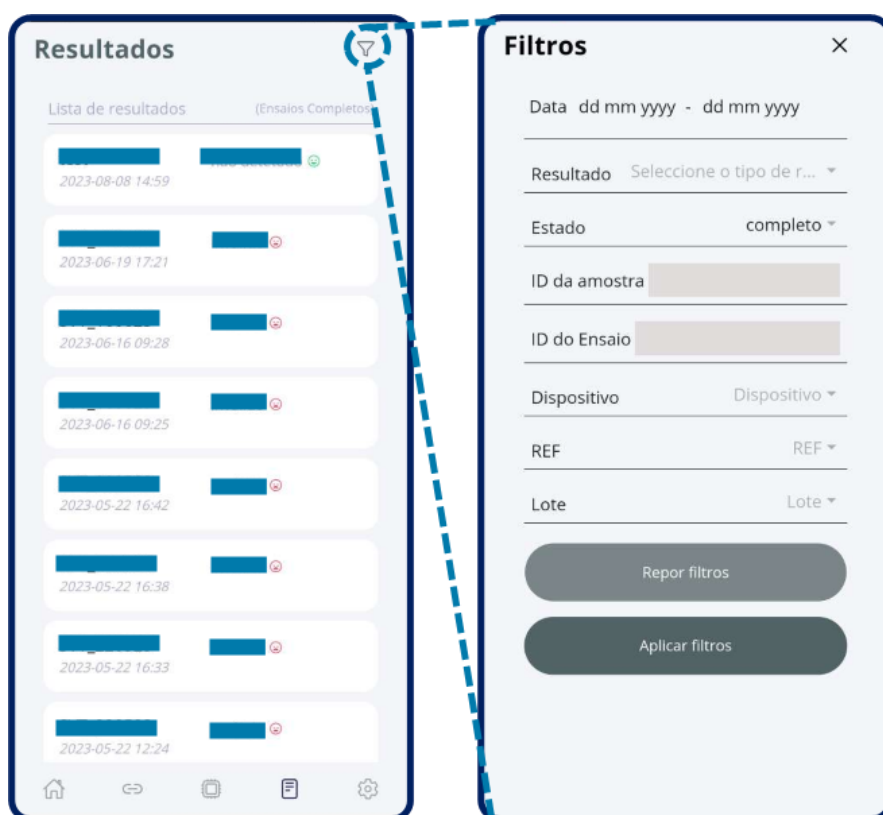

Results

Click on "Results". When the test is finished, it may take up to 2 minutes for the device to transfer all the data to the App. If you want to select a specific test or a type of test, you can apply a filter by clicking on the top right side (red circle).

Click on each trial and the summary of the result will be displayed. Refer to the information on interpreting results in the Instructions for Use provided with the reagents used in combination with the Doctor Vida equipment and Software.

"Invalid result" – An "Invalid" result means that the test has not been successfully performed and that it is necessary to repeat the test or take a new sample.

You can resend the certificate by selecting the user and/or patient again and click on "Resend Certificate".

Doctor Vida
seus testes genéticos

TESTE GENÉTICO MOLECULAR
DETEÇÃO DE INTOLERÂNCIA A LACTOSE PRIMÁRIA



Nome do utente:
Bruce Wayne
Número de utente de saúde:
933992
E-mail:
fernando.dominguez@seuvida.com

Referência da amostra: S/T_20423
Tipo de amostra: Escalado oral
Documento de identificação: 272420300
Data do envio: 28-04-2023 10:13
Data do Emissão Relatório: 29-04-2023 11:36
Técnico responsável: Fernando Egas

Descrição do estado:
Detecção do polimorfismo -13910 C/T no gene MCM6 associado à persistência da lactase.

Indicação clínica:
Suspeita de intolerância à lactose.

Genótipo:
-

Conclusão:
Um resultado "inédito" significa que o teste não foi realizado com sucesso e é necessário repetir o teste ou fazer nova coleta de amostra.

Comentários:
1) A intolerância à lactose em adultos não é uma doença genética, mas sim uma característica ancestral.
2) Este teste não é um diagnóstico in vitro.
3) O teste é válido apenas para a população caucasiana.
4) Em crianças em particular até aos 11 anos, a análise do polimorfismo LCT-13910 C/T produz um resultado preditivo, contudo o teste pode ser usado como método de rastreio para a intolerância à lactose na fase adulta.

Director Técnico: Technical Dummy
Cédula profissional: 25423

Assinatura



THIS REPORT WAS PRODUCED BY AMPLIFICATION OF ALPHA GALACTOSIDASE (TAGAL) LAMP PCR. DETECTION OF POLYMORPHISM AT LACTASE PERSISTENCE 13910 C/T.
 IDENTIFICATION: LMS-REPORT-001-APP-001
 EM CASO DE DÚVIDAS CONTACTE O E-MAIL: info@seuvida.com

Issuance of reports as shown in the example

The report will be sent to the User.

Check that the information issued is always correct. Examples are shown below.

After the rehearsal

Maintenance

The equipment is designed and manufactured for a long life cycle with reduced maintenance requirements. The equipment does not contain internal components that require maintenance by the operator.

The following maintenance actions should be performed regularly:

Maintenance task	Periodicity
Equipment cleaning and disinfection	After each use
Cleaning and disinfection of the site	In accordance with applicable regulatory practices

Site and equipment cleaning

At the end of each test, ensure that the different locations are clean and ventilated as well as all the equipment used in the test, including the Doctor Vida equipment and ensure that the disposal of the reagent tubes and all inherent material is carried out in accordance with the rules of biological waste treatment and in accordance with the regulatory guidelines.

► After the analysis, open the lid of the Doctor Vida equipment, remove the reagent tube and dispose of it in the biological waste;

► Also dispose of consumables and accessories provided in the biological waste;

► Clean the outside of the Doctor Vida equipment with paper moistened with 70% ethanol (do not spray) as well as the lid and let it air dry;

Note: Be careful not to get ethanol into the hole where the reagent tube is placed.

► Clean and disinfect work surfaces with 10% bleach and 70% ethanol to mitigate the risk of contamination;

Keep the place clean and ventilated, daily natural ventilation;

Keep the lid of the equipment open until a new test;

Dispose of the papers and gloves used to clean the space and equipment for biological waste.

Note: Do not leave Doctor Life equipment on if you are not using it.

Waste disposal

Waste electrical and electronic equipment (WEEE) (Directive 2012/19/EU)

Equipment should not be disposed of like other household waste. It is your responsibility to dispose of the equipment properly for the recycling of waste electrical and electronic equipment. The collection and selected recycling of this equipment helps to conserve natural resources and protect human health and the environment. For more information on where you can dispose of the equipment, contact the manufacturer or the distribution company where you purchased the product.

Troubleshooting

Observed problem	Possible solution
—Electricity failure while the test is running. In this case it is not possible to complete the test.	<ul style="list-style-type: none">▶ Turn off the machine and close the app.▶ Open the Dr Vida Pocket PCR app.▶ Discard the test tube that was in use and restart the process using a new test tube.
—Failed to start the test.	<ul style="list-style-type: none">▶ Make sure you have an internet connection and that Bluetooth is working.▶ Check the hardware compatibility requirements of your device with the Dr Vida software in the compatibility section within each store (Android/iOS).▶ Turn off the app and reconnect to the device.▶ Turn off the device and pair again in the App, in the "Devices" menu.
—Data transfer failed. —The application takes too long to display results or the test appears to be stuck.	<ul style="list-style-type: none">▶ Close the Dr Vida Pocket PCR app.▶ Check your internet connection and Bluetooth.▶ Open the app in the "Devices" menu, reconnect the device. Press the device button again and click "continue".▶ If it continues to fail, unpair the machine and pair again. It is important to check that the same device is not connected to more than one mobile phone.▶ If you are able to start a new test with this machine, it means that a power failure has occurred or the machine has automatically restarted. In this case, the test becomes invalid. Discard the test tube that was in use. Turn the equipment off and on again and start the process using a new test tube.▶ If the problem persists, please contact technical support. See the "Manufacturer Information" section.
—The device does not appear in the list of devices. —The connection between the device and the mobile phone failed.	<ul style="list-style-type: none">▶ Check that the equipment is connected to the mains, that there is no electrical fault (e.g. the connection cable is damaged).▶ In the phone's settings, check if Bluetooth is turned on, and if in the app you have given permission to access the device's location.▶ Refresh the screen by swiping down.
—Failed to send the report with the results of the App to the customer's email.	<ul style="list-style-type: none">▶ Contact technical support. See the "Manufacturer Information" section.
—The phone ran out of space to store the data.	<ul style="list-style-type: none">▶ If your phone runs out of space before starting the test, you should free up space on your phone or use another phone.▶ If your phone runs out of space during the test, the test continues, however, the results will not be available. In this case, do not turn off the equipment as the data is stored on the device. Free up space on your phone and the connection will be re-established.

Important note: If you turn off the equipment you lose all data and you must repeat the test with a new test tube.

► When the result is detected, but the growth of the curve is not exponential, the analysis must be repeated with a new test. This type of result can occur when:

- 1) There is current oscillation
- 2) When the lid is opened during the test.
- 2) When the equipment moves sharply or tilts.

—Result with atypical/invalid graph.

Warranty Information

The product is covered by a two-year warranty period. This warranty is intended to protect you from the costs associated with problems resulting from manufacturing defects. The warranty period begins on the date of receipt of the product at the desired location. For assistance during the warranty period, contact the manufacturer.

Training

These instructions for use describe the correct use and operation of the device. Operators of the device should familiarise themselves with the applicable sections in the document before testing to ensure safe and efficient use of the document. Make sure you follow the training requirements in accordance with the applicable regulatory guidelines. If you need more information about training in the use of this product, please contact the manufacturer.

Manufacturer Information

Name: STAB VIDA- Research and Services in Biological Sciences, Lda.

Address: Madan Parque, Rua dos Inventores, Sala 2.18, 2825-182 Caparica, Portugal.

Sítio(s) web: <https://www.stabvida.com>

Technical assistance:



+351 938 437 766

In case of any problem, please contact us by email drvida@stabvida.com or phone 00351 938 437 766 (Call to national mobile network)

Monday to Friday from 8:30 am to 17:30 pm. (GMT time)

According to EU regulation 2017/746, any serious incident that occurs in connection with the device must be reported to the manufacturer and the competent authority of the EU Member State where the user and/or patient is established.

Revision history

Revision		Revised points	
N.º	Date (dd/mm/yy)	N.º	Review Description
1	04/11/2022	All	Issuance of the document considering the Equipment and Software set.
2	18/01/2023	All	Adaptation to the requirements of the standard (IEC/EN 61010-1)
3	18/01/2023	All	Adaptation to the requirements of the standard (IEC/EN 61010-1)
4	31/03/2023	All	Adaptation to the requirements of the standard (IEC/EN 61010-1)
5	28/04/2023	All	Compliance with Regulation (EU) 2017/746 IVDR Quality control: Inclusion of reagent considerations for quality controls of product-compatible tests. Manufacturer information: Updating the telephone contact number for technical assistance. Adding .of QR Code
6	28/08/2024	-	Added the list of used abbreviations. Added graphics and illustrative schemes. Added QR code for information relating (features) to Doctor Vida products. Change of technical support contact number Updated the troubleshooting list
7	04/02/2025		Updated the document for research use only purposes